



**DENTAL**

Metal **DryLyte** Electropolishing

# **DLyte**100D<sup>®</sup>



**DLyte 100D**<sup>®</sup> new patented machine for grinding and polishing steel and stainless-steel (chrome cobalt alloys for dental industry). Available for all types of dental skeletal, spacers, implants and orthodontics brackets. Capacity of **9 pieces** for each working cycle with an average of 50-60 minutes time cycle.

Machine patented and manufactured by

**GPAINNOVA**



The use of Patented DryLyte Technology is a concession approved by DryLyte Company

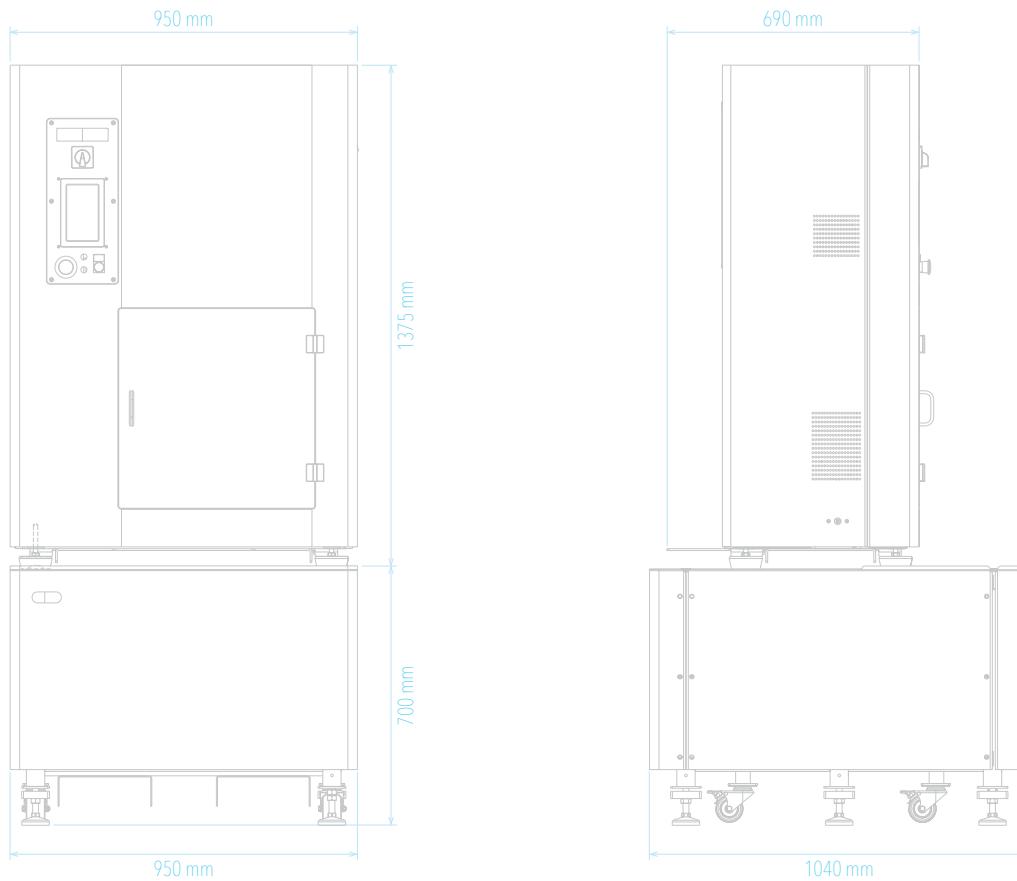

MODEL	<b>DLYTE 100D</b>
CAPACITY	9 pieces
MACHINE DIMENSIONS	950 x 690 x 1370 mm
SUPPORT DIMENSIONS	950 x 1040 x 700 mm
MACHINE WHEIGHT	250 kg (230 V) - 275 kg (110 V)
SUPPORT WHEIGHT	77 kg
POWER	5 kW
VOLTAGE	220-240 V or 110-115 V
AIR PRESSURE	4-5 bar

Consumption of 40 l/min. Quality air according ISO 8573 must be 1.5.1\*.  
 (\*) Air quality required for maintenance (Change filters) every 6 months.

## Consumables and Accessories



**ELECTROLYTE DLYTE-01 FOR 100D**



**ELECTROLYTE DLYTE-02 FOR 100D**



**HOLDER 100D**

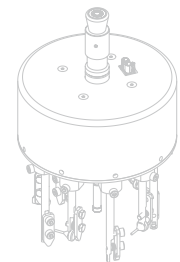

**VIBRATION HOLDER 100D**